

Legacy Park

CRIDERSVILLE, OHIO

***Celebrating the heritage of our
community and its commitment
to lifelong learning***

The Village of Cridersville is partnering with our local Lions Club and Historical Society to develop a wonderful park on the site of our former Cridersville School at 300 E. Main Street. We invite you to learn more about the project and hope you will want to become involved in making it a reality.



LIFELONG LEARNING

What Legacy Park Will Include

This is a major project for the Cridersville community. As with all big, meaningful projects it will take time, money, and a lot of community support and involvement. But, the benefits to our residents—especially our children—will be a lasting legacy for our community.

Here is what our landscape architects, who have donated their time on this project, have suggested for the new park.

THE COMMONS —

a large open lawn defined by a circular walking path. It will become the perfect spot for active play and impromptu games. Plus, it will be great for lawn-chair seating for concerts and outdoor movies.



THE CIRCLE WALK —

a giant circular walk that will define the Commons and provide a great place to walk, or maybe even jog. Plus, there will be plenty of benches along it for just sittin’.

THE ONE ROOM SCHOOL SHELTER —

an open-air shelter house designed to resemble Cridersville’s original one-room schoolhouse. It will provide space for family picnics, a staging area for concerts, and an optional screen for outdoor movies. It will also be the location for restrooms.

THE SPLASH PLAY AREA —

the place to find relief from the summer heat. The Splash Park will allow kids and their families a bit of water fun. The design calls for water jets to come out of the concrete walks and plenty of seating for “older” folks to enjoy the show. Its design theme will interpret Cridersville’s Big Fire of 1918. Water cannons will simulate fighting the fire.



THE MEMORIAL GARDEN MAZE —

a fun and exciting maze with garden elements that resemble oil derricks, low maintenance landscaping, and plenty of seating. It will be designed to tell the story of Cridersville’s local history.

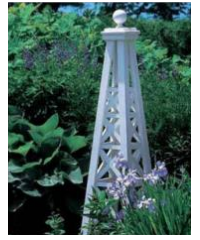

THE LEGACY GATE —

remembering this site’s importance to our children, families, and community. An entry gate along the school’s original sidewalk will be constructed from bricks and architectural elements saved from the former building.

THE LEARNING CHILDREN STATUES —

at the entry, and other locations in the park, there will also be life-size bronze statues of children learning — the true legacy of the site.



TELLING THE STORY —

taking every opportunity to



celebrate the heritage of our community. The park will be filled with design elements and interpretive signs that highlight local history. From

the Shawnee trail that became Main Street to the founding by Ephraim & Polly Crider, the coming of the railroad, and much more, Legacy Park will tell the story of Cridersville—and make it fun.

TABLE OF CONTENTS

What The Park Will Include	1
Legacy Park Master Plan	2
Getting Started	3
Phase One Plan	4
Fund Campaign	5
Donor Options	6
Legacy Gate & Memorial Garden	7
Shelter House & Splash Play Area	8
Bronze Statues of Children	9
Project Partners	10

The design for Legacy Park was a pro bono project of Garmann Miller Architects in Minster, Ohio.

PARKING AREA

TO
TOWER
PARK

HIGH STREET

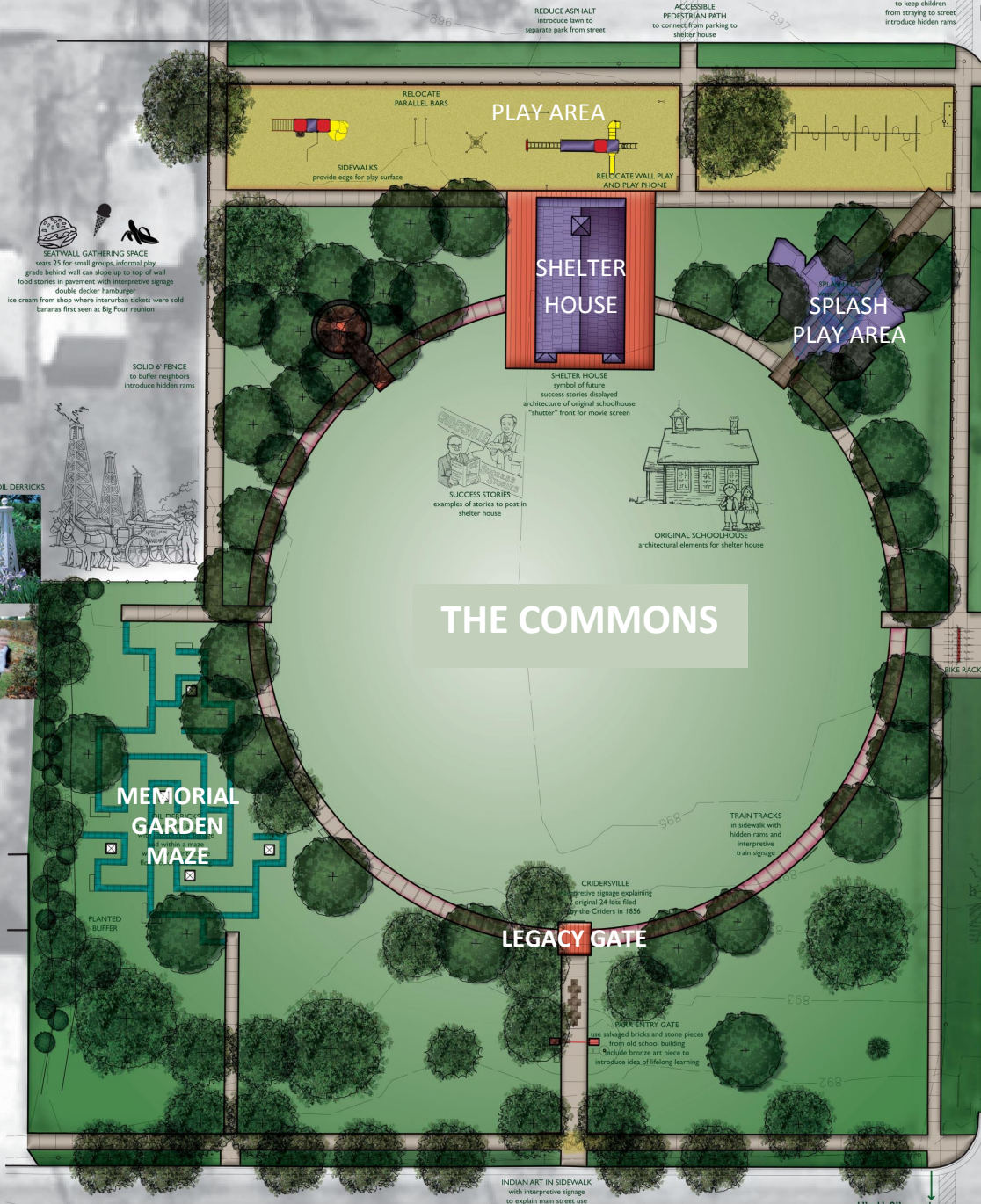

WATER STREET

REDUCE ASPHALT
introduce lawn to
separate park from street

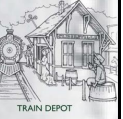

MAIN STREET



LEGACY PARK SITE CONCEPT

04.23.12

Making the plan a reality

Legacy Park is a big project. Making it happen will take several years and many good people. The Village of Cridersville now owns the former school site. The Cridersville Lions Club has agreed to manage the logistics of a capital campaign and construction phases. The Cridersville Historical Society will serve as fiscal agent for the project. Plus, it will provide all of the required historical information.

This project also needs the help of local citizens, families, and businesses. It will need support from Cridersville School alumni now living throughout the country. The Village will seek grants to help with funding. We will also seek in-kind labor and materials for the project. It will take all of us, working together to make Legacy Park a reality.

Legacy Park GETTING STARTED

Legacy Park is a major endeavor. We anticipate it may need to be done in phases. The first phase will include the following:

HARDSCAPE

Concrete sidewalks for the Commons and Memorial Garden Maze

SOFTSCAPE

Lawn, trees, shrubs, perennials

SITE FURNISHINGS

Entry gate, interpretive signage, lighting, benches, litter receptacles, bike racks, fencing

With engineering fees and contingency, the total estimate for Phase One is \$189,000.

In addition to the Fund Campaign, we plan to seek grant funding and in-kind donations of labor and materials. There will also be many opportunities for memorial gifts to the park.



PHASE ONE PLAN

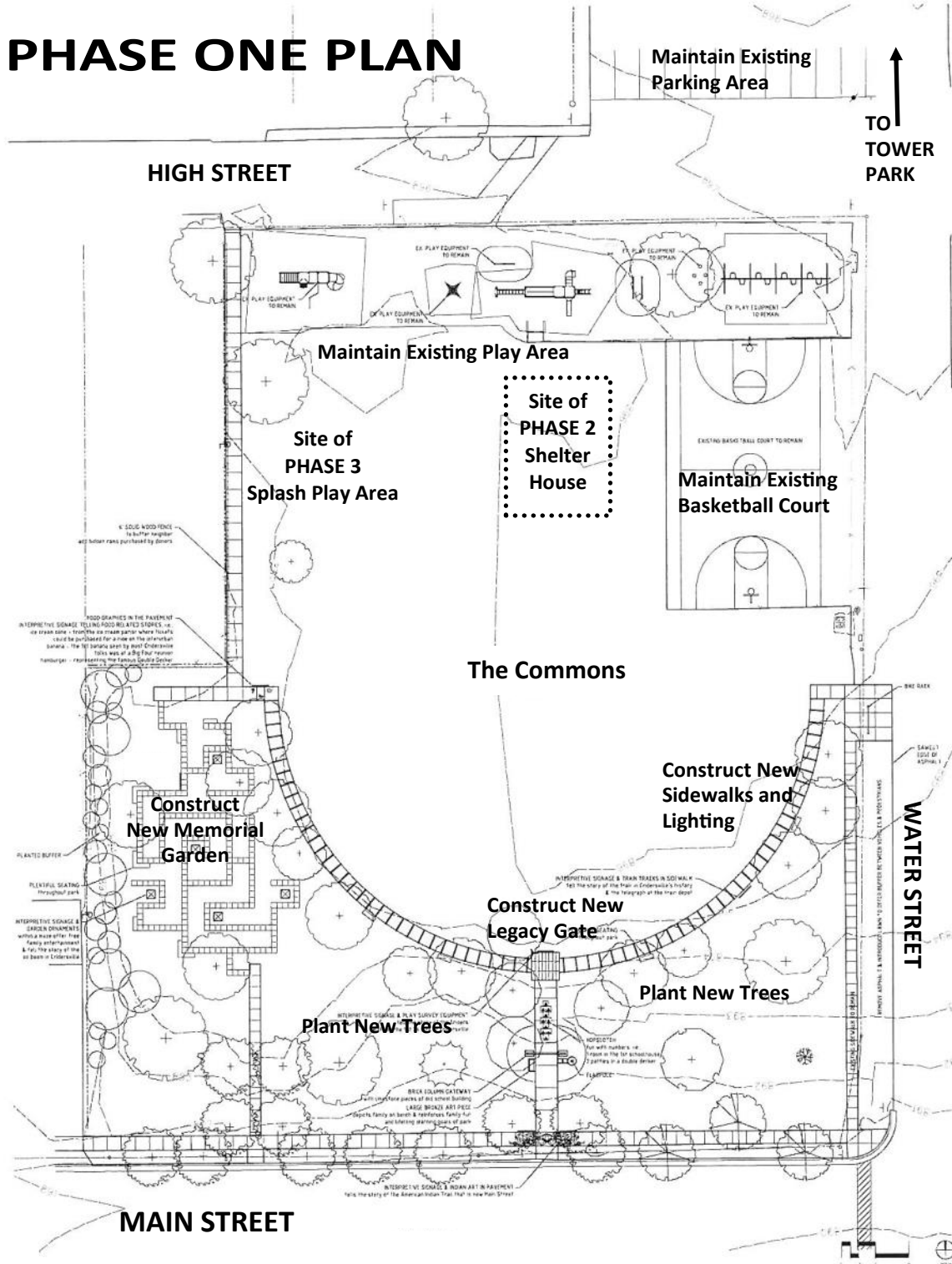

04.24.12

Here is how you can help.

LEGACY PARK FUND CAMPAIGN

Legacy Donor — \$5000 or more

Gold Level Donor — \$1,000 to \$5,000

Silver Level Donor — \$500 to \$1,000

Bronze Level Donor — \$250 to \$500

Friend of the Park — any gift under \$250

Legacy Park donors are encouraged to consider sponsoring a specific component of the park. Several options are outlined on Page 6.

Please contact us for details. All donors will receive recognition in the park. Donors at the Bronze Level or higher will be honored with a special Rams Head marker.

Please make checks payable to:

Cridersville Historical Society

Note as Legacy Park Fund

PO Box 2444

Cridersville, Ohio 45806

As a 501(c)3 not-for-profit, charitable organization, your donations are fully tax deductible.



Legacy Park

CRIDERSVILLE, OHIO

Plant Your Family Tree Program



Tree selections to be planted in Legacy Park are listed below. In order to help the trees survive in a park environment and speed up their shade potential, all trees planted will be sized at 2"-2 1/2" diameter. A remembrance plaque will be included in each planting with your family name and tree species. Cost per tree is \$400.

← Sample of 2 1/2" diameter →

SHADE & ORNAMENTAL TREES:

Red Sunset Red Maple

European Hornbeam

Shademaster Honey Locust

Tulip Tree — Bald Cypress

White Oak — Pin Oak — Red Oak

Redmond American Linden

Valley Forge American Elm

Shadblow Serviceberry

Winter King Hawthorn

BUILD A BENCH

Legacy Park will provide a great place for playing and walking—plus plenty of benches for just sittin'. You may want to consider purchasing one of the park benches in memory of a family member or friend. The benches are high quality and low maintenance. Each will include a recognition plaque. A sample bench is already in place near Main Street. Cost for a bench is \$750



BUY A BRICK

Individuals, families, and businesses can support the project by purchasing an engraved brick that will be built into the Legacy Gate and other components of the park landscape. Bricks will be available in two sizes — 4"x 8" or 8"x8". This is a perfect opportunity to add your name, your family name, or a memorial name to the project. Smaller size bricks are \$100 and larger bricks are \$250.



ADOPT A STATUE

At the Legacy Gate and other locations in the park, the plan calls for life-size bronze statues of children learning. We believe that is the true legacy of the site. The statues are cast in bronze and include a variety of sizes — a single child and two or more in groupings. The statues range in price from \$2000 to \$4000. A statue could be the perfect idea for a company, church, or civic organization investment in the project.



Legacy Gate & Memorial Garden

LEGACY PARK GATE



Above: A design concept of what the Legacy Park Gate might look like.

Below: Architectural elements saved from the former school building—to be used in the gate and other park structures.

A memorial entrance gate will be constructed on the main sidewalk coming from Main Street—the walk that once lead to the school's entrance. The gate's design will include the architectural elements (shown below) that were saved from the former school building. The gate will also include engraved bricks with individual, family, and memorial names. If funding is made available, the gate design will also include a 63" tall, bronze ram statue. The ram was the mascot for Cridersville School. It seems appropriate that a ram should welcome visitors to Legacy Park.



63" High x 44" Wide
Bronze Ram Statue
Cost: \$4,000

ESTIMATED COST: \$10,000



MEMORIAL GARDEN MAZE

The Memorial Garden will be constructed in the northeast section of Legacy Park. It will be designed with a maze-like, imprinted sidewalk. It will include a low maintenance perennial landscape, garden elements that will resemble oil derricks (an important part of Cridersville's past), and plenty of seating—with maybe a swing or two. It will be a beautiful and fun way to tell our local history story. We think it will be a favorite spot for folks of all ages.



**ESTIMATED
COST: \$8,000**

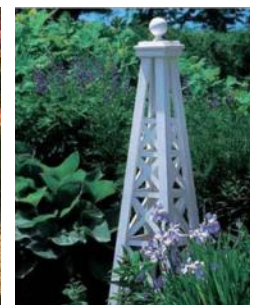

One Room School & Splash Play Area



The first Cridersville school was built in 1866. It was a one-room schoolhouse located in the 200 block of E. Main Street.

ONE ROOM SCHOOL SHELTER HOUSE

The design for Legacy Park plans for a shelter house at the south end of the Commons adjacent to the play area. This open-air shelter will be designed to resemble Cridersville's original one-room schoolhouse. It will provide space for family reunions and picnics, a staging area for community concerts, and a screen for outdoor movies. Attendees for the concerts and movies will be seated on lawn chairs and blankets in the adjacent lawn of The Commons. The shelter house will also be the location for the Legacy Park restrooms. It is planned as part of the project's Phase Two.

ESTIMATED COST: \$75,000

SPLASH PLAY AREA

Who doesn't love a splash of cool water on a hot summer day? The Legacy Park Splash Play Area will be the place to find relief from the summer heat. It will provide kids and their families a bit of water fun. The design calls for a series of water jets to come out of the concrete sidewalks and plenty of seating for the "older" folks to enjoy the show.

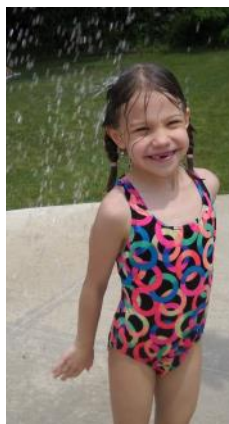

Its design theme will interpret the history of Cridersville's Big Fire of 1918—the day when the village's downtown was destroyed by fire. Plastic play equipment adjacent to the splash area will be designed to resemble several of the buildings prior to the fire. Water cannons will simulate fighting the fire. It should be great fun! This will be a Phase Three project.

ESTIMATED COST: \$100,000



Lifelong Learning Statues

BRONZE STATUES OF CHILDREN LEARNING



Another special component of Legacy Park's master plan is the bronze statues of children. These statues are nearly life-size and show the children learning—the true legacy of the park site. Since 1939, this was the place where many generations of Cridersville's children came to learn and achieve. It seems highly appropriate that scattered throughout the park there should be several of these bronze kids with their books in hand—a reminder of what this place meant to all the children and families of Cridersville.

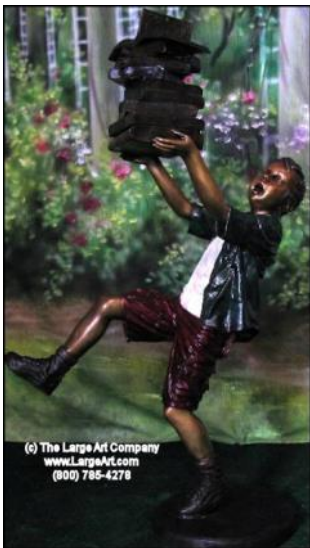

The statue options include a variety of sizes from a single child or two or more in groupings. The statues range in price from \$2000 to \$4000. A statue could be the perfect way for an individual, company, church, civic organization, or past graduating class to invest in the project. Each statue will include a donor plaque. Plus, bronze lasts forever.

ESTIMATED COSTS: \$2,000 - \$4,000



Legacy Park PARTNERS

Legacy Park is a project of the

VILLAGE OF CRIDERSVILLE
CRIDERSVILLE LIONS CLUB
CRIDERSVILLE HISTORICAL SOCIETY



Additional partners include:

Garmann/Miller Architects

Spieles Nursery

Hemleben Concrete Construction

Village of Waynesfield Electric Department

Apollo Career Center

For additional information please contact

Greg Myers

419.733-0568 jnmyers@bright.net



Legacy Park

300 EAST MAIN STREET
CRIDERSVILLE, OHIO

**Celebrating the heritage of our community
and its commitment to lifelong learning**